

B-SIDE BOLLARD

Illuminating Bollard



DESCRIPTION

B-Side is a family of bollards in three heights designed to subtly accent public and private areas with its characteristic bidirectional light distribution. The uniquely styled bollard with central opening is fabricated from die-cast and extruded aluminum components. The light source is concealed from normal viewing angles and provides self-illumination while adding structure to spaces. All models are IP65 rated with an IK10 impact rating, making B-Side an ideal anti-vandal solution for lighting public parks and urban areas. The smallest model can also be installed as an outdoor wall mounted luminaire.



Date: _____ Type: _____ Catalog Number: _____

Project Name: _____

ORDERING INFORMATION

LUMINAIRE				
MODEL	OUTPUT	CCT	VOLTAGE	FINISH
BSB135 5.3" Bollard / Wall Mount*	SO Standard Output	27K 2700K	UNV 120 - 277v	GR Grey
BSB450 17.7" Bollard	HO High Output *(Not available in BSB135 or Amber)	30K 3000K		AG Anthracite Grey
BSB850 33.5" Bollard		40K 4000K		
		A Amber (Standard Output Only; 585-595nm)		

MOUNTING

MODEL
BSIDE-MK Mounting Kit for B-SIDE

B-SIDE BOLLARD

Illuminating Bollard



PHYSICAL		BSB135	BSB450	BSB850
		HOUSING	Die-Cast Aluminum	
	OVERALL DIMENSIONS	5.31" x 6.3" x 6.3"	17.72" x 6.3" x 6.3"	33.46" x 6.3" x 6.3"
	WEIGHT	3.2 lbs	6.2 lbs	9.8 lbs

ELECTRICAL	POWER CONSUMPTION	4 Watts	4.6 Watts Standard Output 6.0 Watts High Output	
	DRIVE CURRENT	500mA	500mA Standard Output 700mA High Output	
	AMPERAGE	0.03A @ 120V 0.01A @ 277V	0.04A (Standard Output) or 0.05A (High Output) @ 120V 0.02A (Standard Output) or 0.02A (High Output) @ 277V	
	CONTROL	On/Off		
	CRI	> 80		

PHOTOMETRIC	LED	2700K, 3000K, 4000K, or Amber		
	DELIVERED LUMEN OUTPUT	Up to 170 lumens		
	EFFICACY	Up to 32 lumens per watt		
	LUMEN MAINTENANCE	50,000 hours @ 77°F*		
	LIGHT CONTROL ACCESSORIES	None		

CERTIFICATIONS	SAFETY	CSA Listed for Wet Locations		
	INGRESS PROTECTION	IP65		
	IMPACT RATING	IK10		
	WARRANTY	Five Year Limited Warranty		

B-SIDE BOLLARD

Illuminating Bollard



DIMENSIONS

All dimensions are shown in inches unless otherwise noted.

BSB135

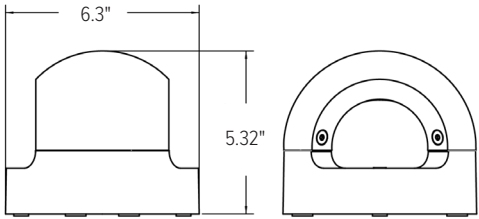

BSB450 **BSB850**

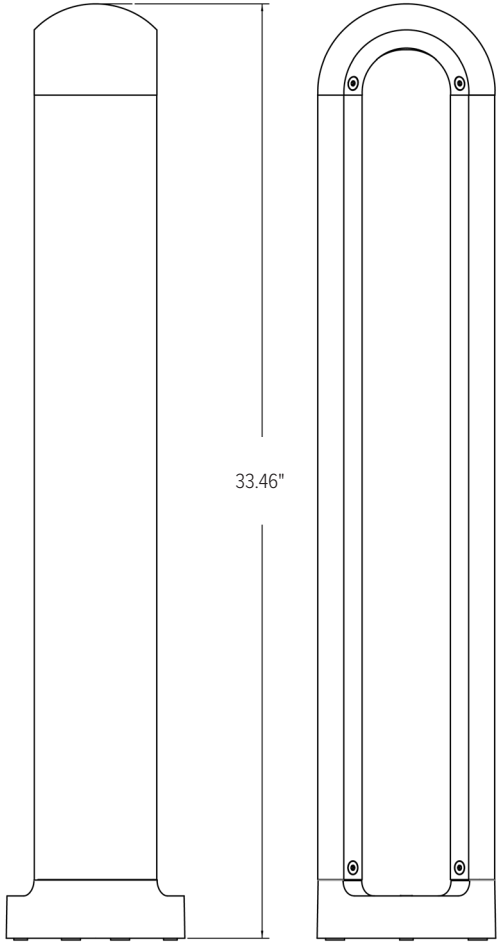
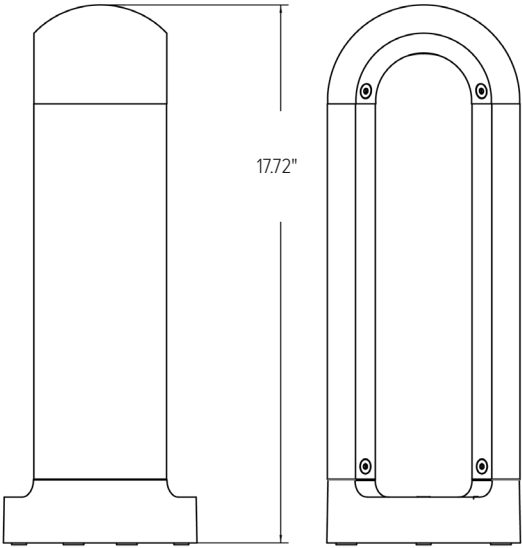

PHOTOMETRY

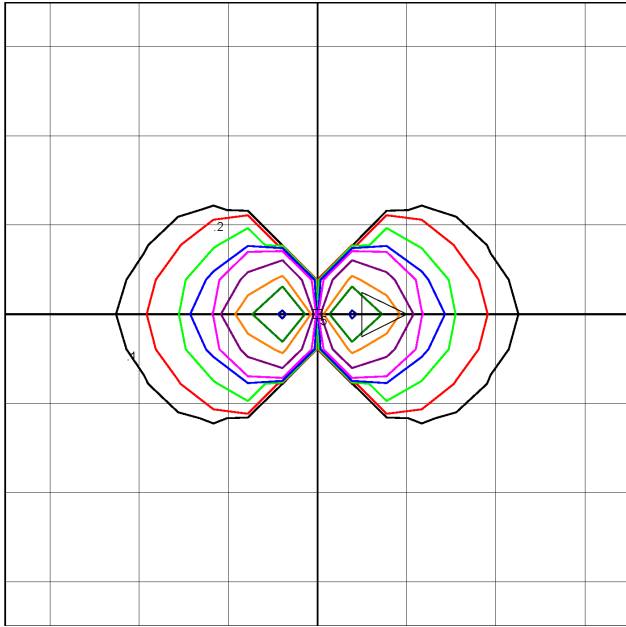

BSB450-HO-40K-UNV-GR:
Mounting Height= 1.5'
Each Square= 2'
Delivered Lumens= 130 lms
Maximum Calculated Value= 55.25 FC

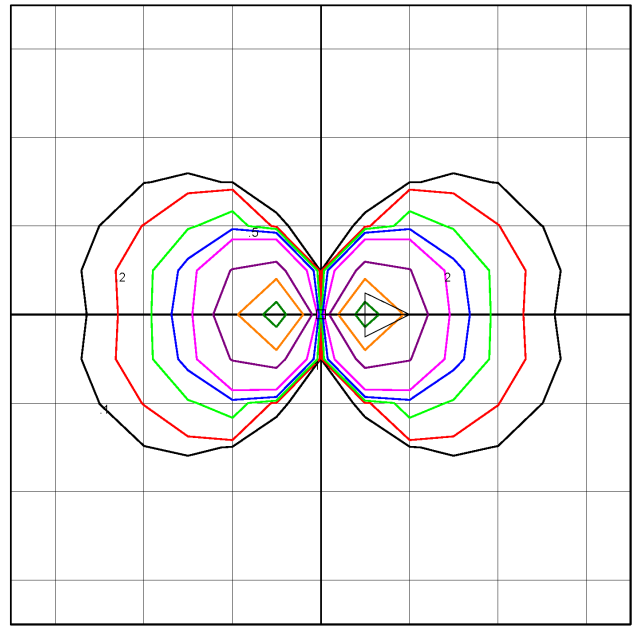

BSB850-HO-40K-UNV-GR:
Mounting Height= 2'
Each Square= 2'
Delivered Lumens= 170 lms
Maximum Calculated Value= 25.51 FC

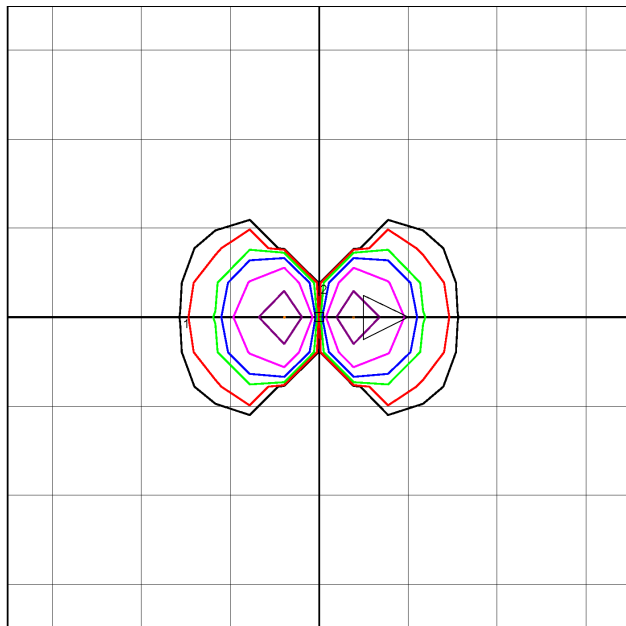

BSB450-SO-40K-UNV-GR:
Mounting Height= 1.5'
Each Square= 2'
Delivered Lumens= 130 lms
Maximum Calculated Value= 10.12 FC

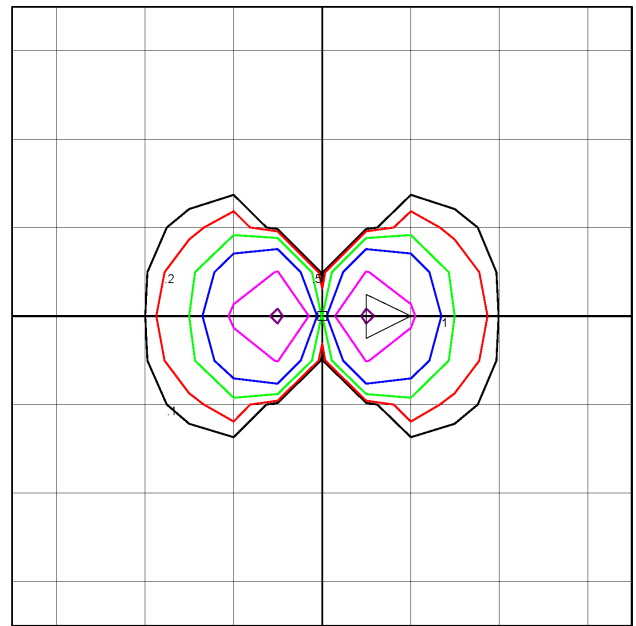

BSB850-SO-40K-UNV-GR:
Mounting Height= 2'
Each Square= 2'
Delivered Lumens= 170 lms
Maximum Calculated Value= 5.61 FC